

SEG Graphic Installation

STEP 1: Attach Corners

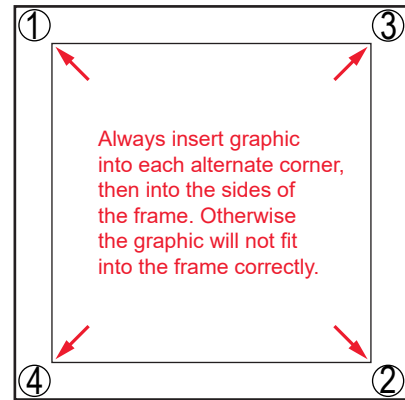

Insert narrow side of silicone welt into the channel at corner 1, with fabric to the outside.

Repeat for opposite corner 2, then corner 3, then corner 4.



STEP 2: Attach Middle

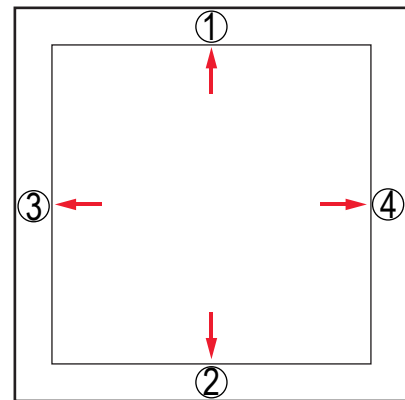

Once corners are attached, press the middle of edge 1 into the channel. Then press middle of edge 2 into the channel on opposite side.

Repeat with edge 3 & 4.

STEP 3: Attach Sides

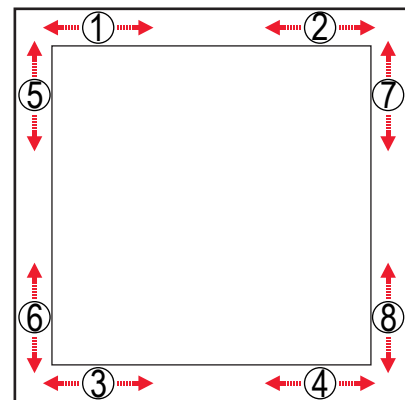

Once the middle of sides are attached, fully press the silicone welt into the channel, between center and corner at location 1. Repeat the process between center and corner at location 2.



To remove the graphic from the frame, locate the fabric **pull tab**. Gently pull on the tab to remove the graphic.

Do the same for welt on opposite side, at locations 3 & 4. Then repeat for locations 5 & 6 and 7 & 8.

Steps:

- 1) Connect power cords to Supernova lights in front & side lightboxes.
- 2) Apply SEG graphics to front & side frame of counter.
- 3) Connect power to charging ports in counter top.

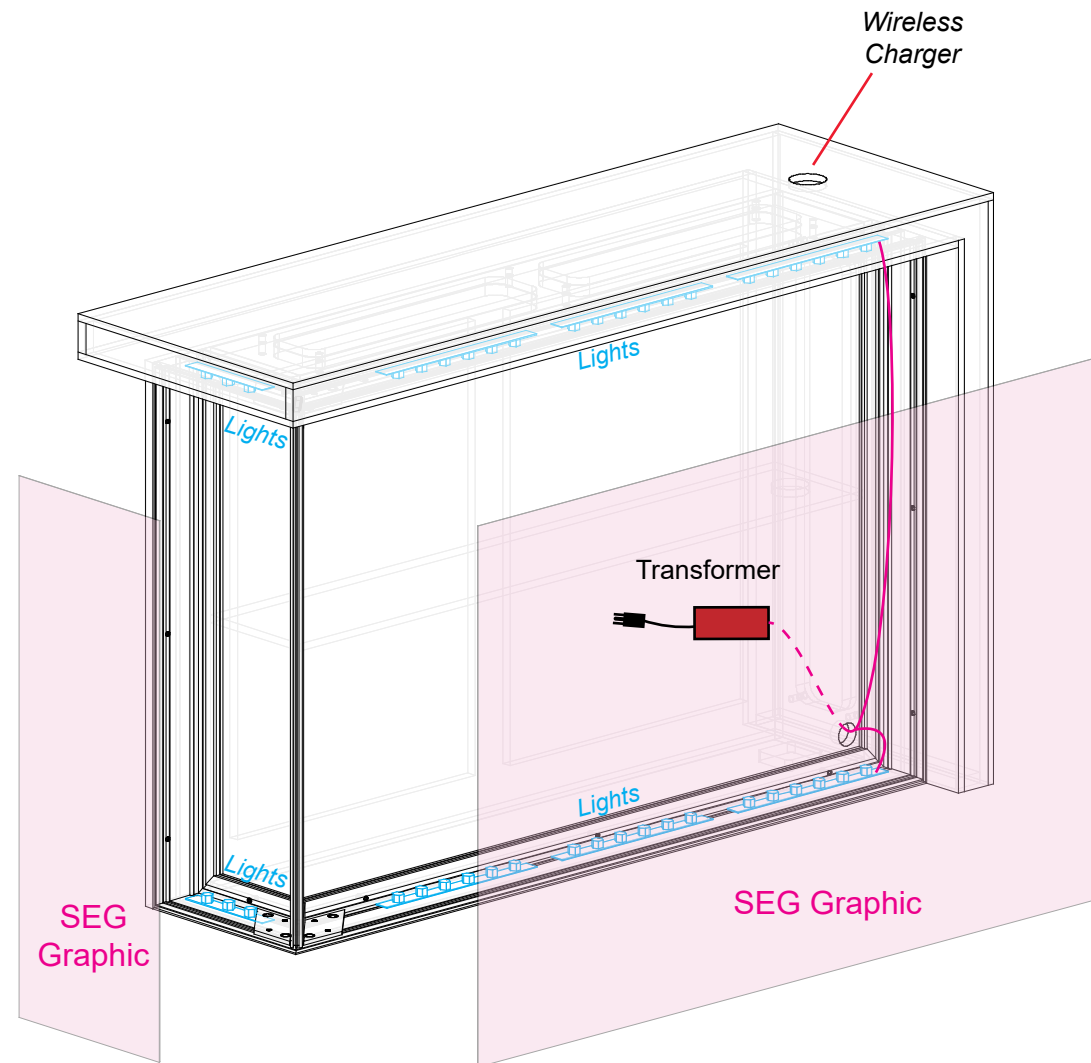

FRONT VIEW

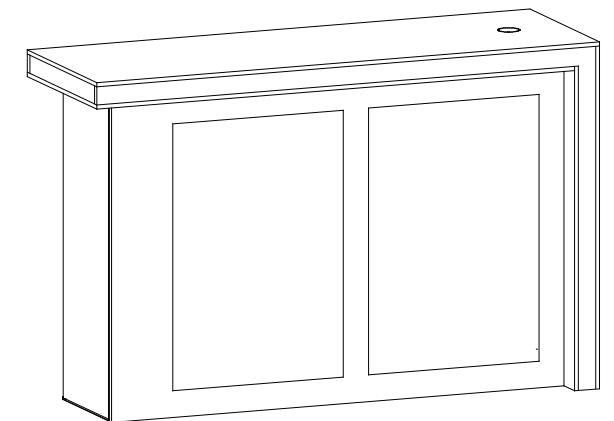

BACK VIEW

Light to Light Attachment

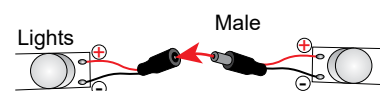

Light to Transformer Attachment

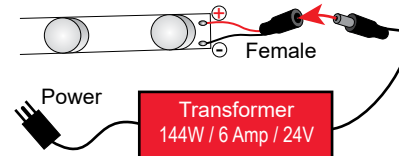

Maximum of 7 lights per chain / 12 lights per Transformer

Keep counter assembled for shipment.
DO NOT DISASSEMBLE.

SETUP INSTRUCTIONS



© 2026

Order #XXXXXX Crate Packing

CRATE PACKING