

FRONT VIEW

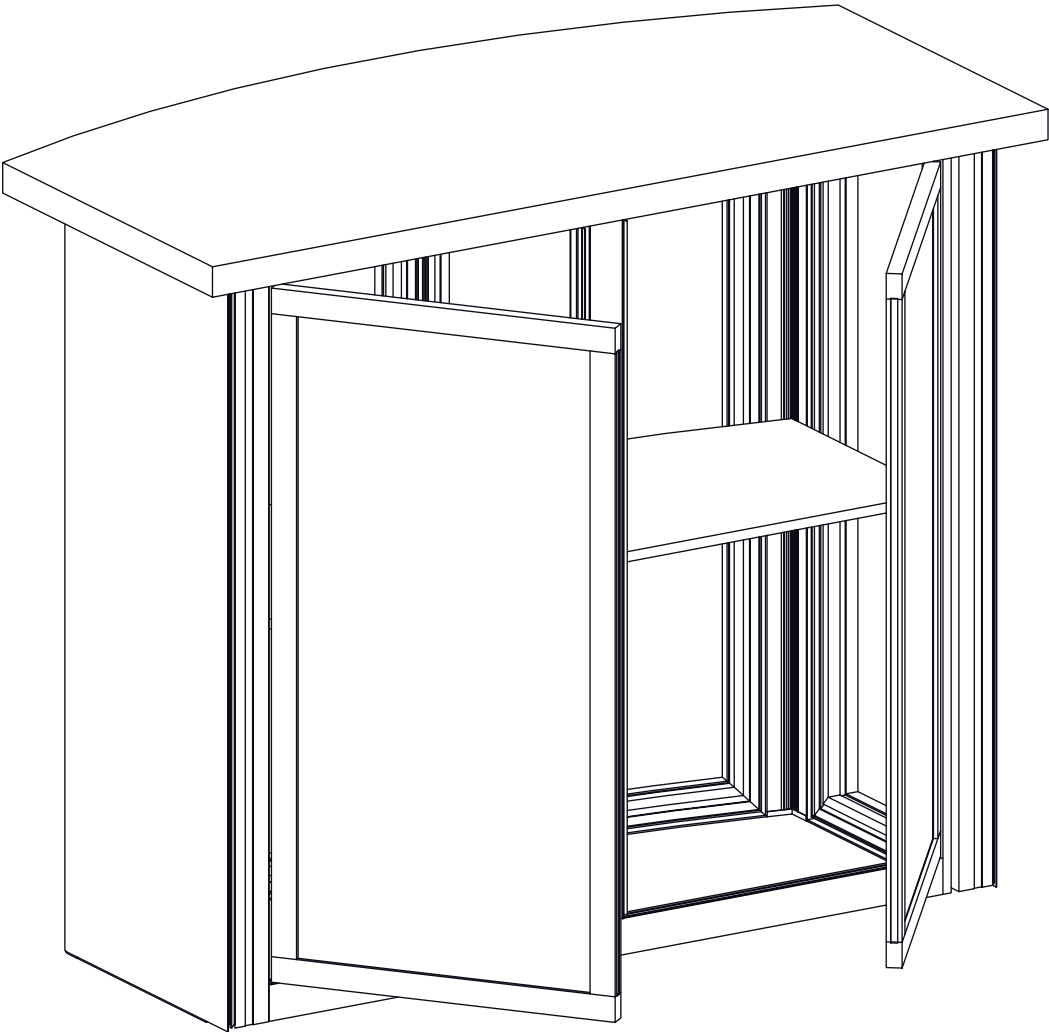

BACK VIEW

**SETUP INSTRUCTIONS**

## General Setup Instructions

- Read entire setup instruction manual prior to unpacking parts and pieces.
- The setup instructions are created specifically for this configuration.
- Setup instructions are laid out sequentially in steps, including exploded views with detailed explanation for assembly.

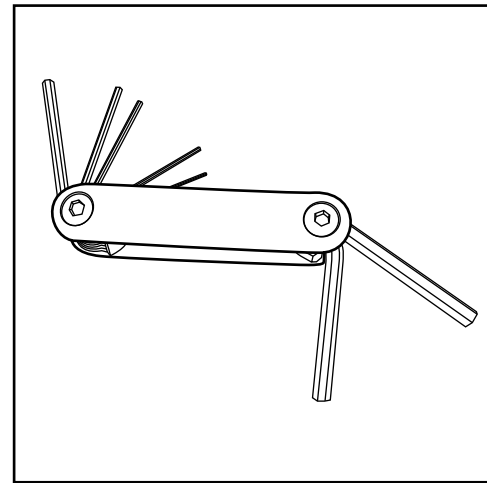

Hex Tool - Essential for Assembly

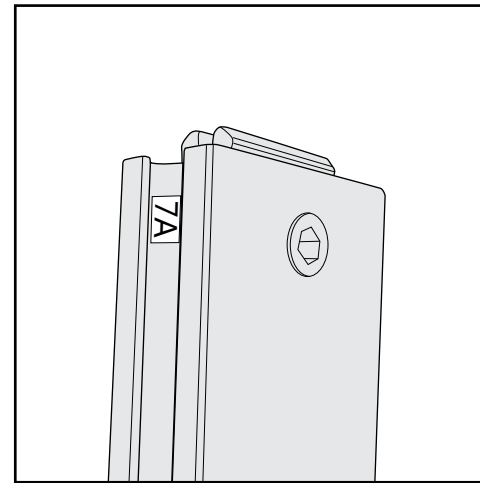

Part Identification - Numbering



# WARNING

## Cleaning & Packing

- For Cleaning Metal, Plex, & Laminate Parts: Use a **MILD NON-ABRASIVE** cleanser and soft cloth/paper towel to clean all surfaces.
- Keep exhibit components away from heat and prolonged sun exposure.  
**Heat and UV exposure will warp and fade components.**
- Retain all provided Packing Materials. All provided packing materials are for ease of repacking & component protection.

## Disassembly

- For loss prevention, tighten all set screws and locks during disassembly.

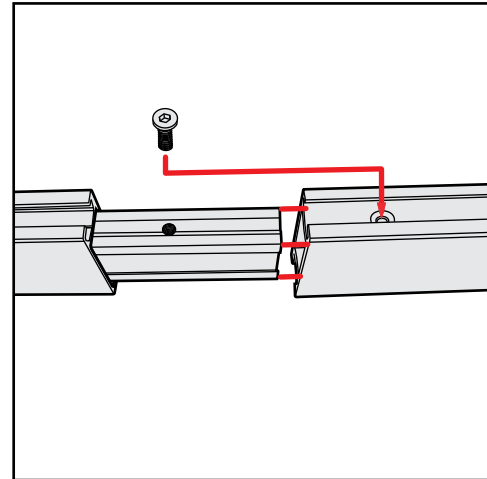

Spline Connection

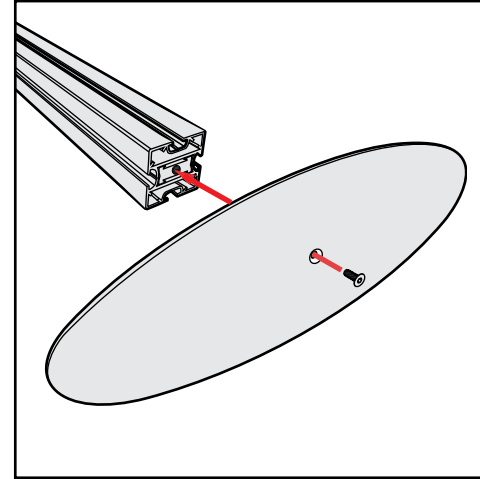

Base Plate & Extrusion Connection



DO NOT USE POWER TOOLS



LADDERS OR LIFTS  
MAY BE REQUIRED

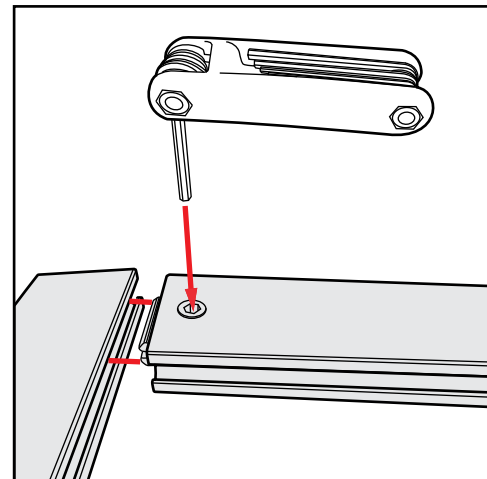

Extrusion & Lock Connection

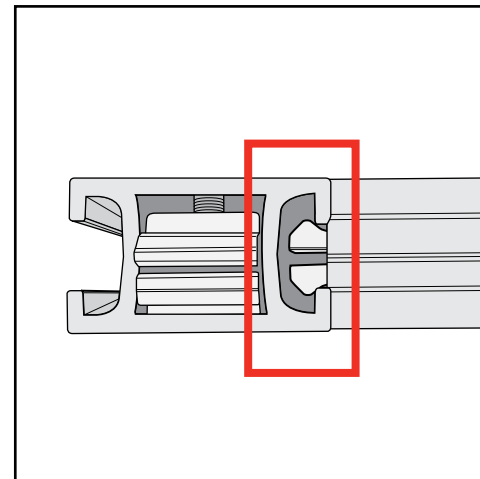

Engaged Lock



ALL CONNECTIONS MUST  
BE TIGHTLY SECURED

## General Setup Instructions

- Read entire setup instruction manual prior to unpacking parts and pieces.
- The setup instructions are created specifically for this configuration.
- Setup instructions are laid out sequentially in steps, including exploded views with detailed explanation for assembly.

## Cleaning & Packing

- For Cleaning Metal, Plex, & Laminate Parts: Use a **MILD NON-ABRASIVE** cleanser and soft cloth/paper towel to clean all surfaces.
- Keep exhibit components away from heat and prolonged sun exposure.  
**Heat and UV exposure will warp and fade components.**
- Retain all provided Packing Materials. All provided packing materials are for ease of repacking & component protection.

## Disassembly

- For loss prevention, tighten all set screws and locks during disassembly.

Assembly

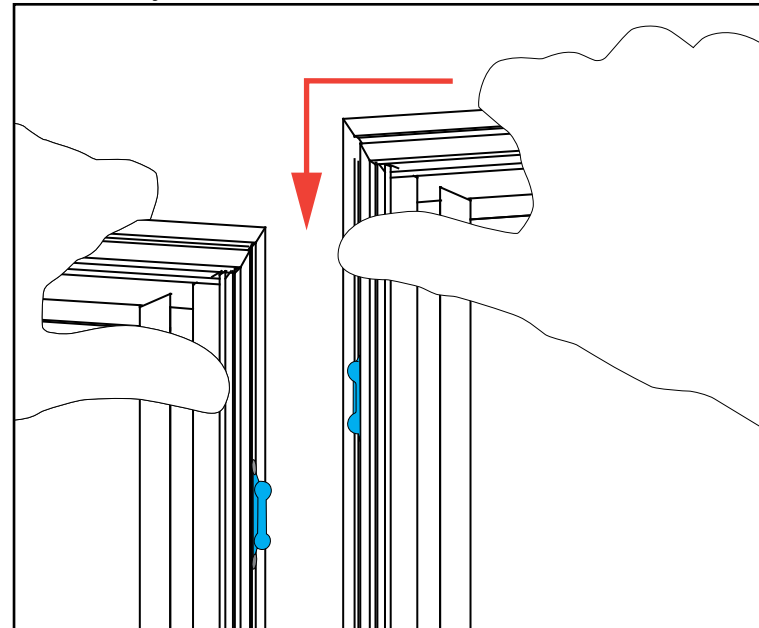

### Side-by-Side Assembly

- 1) Frames: Place frames side-by-side with one higher than the other, then slide panel down to lock panels securely together.
- 2) Corner Connectors: Repeat Step 1 for installing corner connectors to frames.

Assembly Cont'd

Push pin lock into hole of connecting frame.  
Note: Block on pin lock will secure in groove.

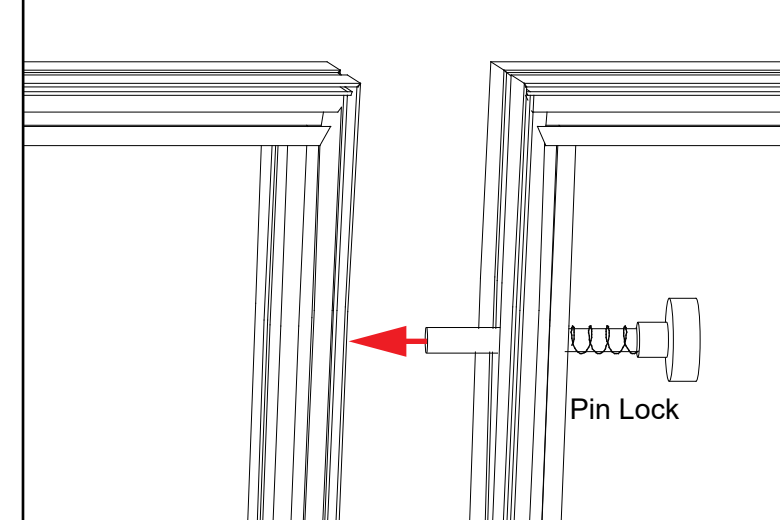

### Side-by-Side Disassembly

- 1) Pull pin lock outwards to disengage.
- 2) Pull frames upward and apart at the same time to detach.

## SEG Graphic Installation in 3 Steps

The Perfect Fit

### STEP 1: Attach Corners

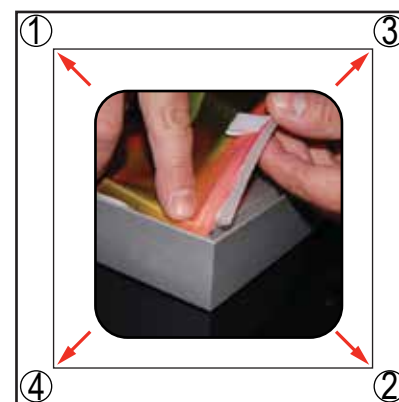

Always insert graphic into each alternate corner, then into the sides of the frame. Otherwise the graphic will not fit into the frame correctly.

Insert narrow side of silicone welt into the channel at corner 1, with fabric to the outside. Repeat for opposite corner 2, then corner 3, then corner 4.

### STEP 2: Attach Middle

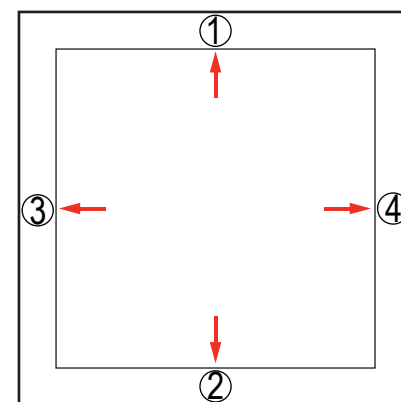

Once corners are attached, press the middle of edge 1 into the channel. Then press middle of edge 2 into the channel on opposite side. Repeat with edge 3 & 4.

### STEP 3: Attach Sides

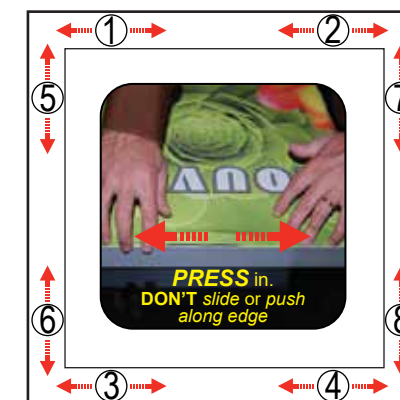

Once the middle of sides are attached, fully press the silicone welt into the channel, between center and corner at location 1. Repeat the process between center and corner at location 2.



To remove graphic from the frame, locate the fabric pull tab. Gently pull on the tab to remove the graphic.

Install video:



Top View of Each Level

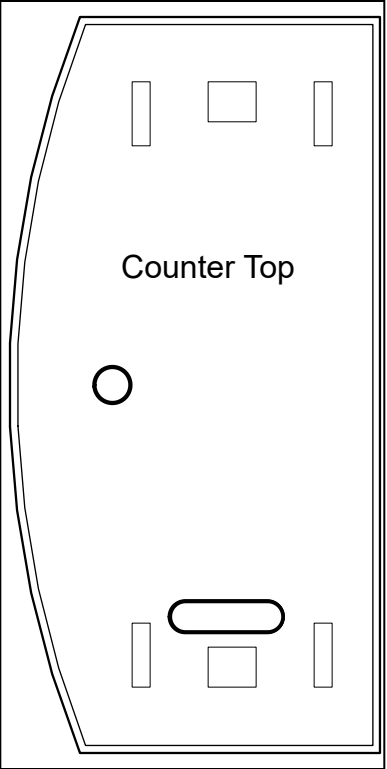

Level 1  
(Bottom level)

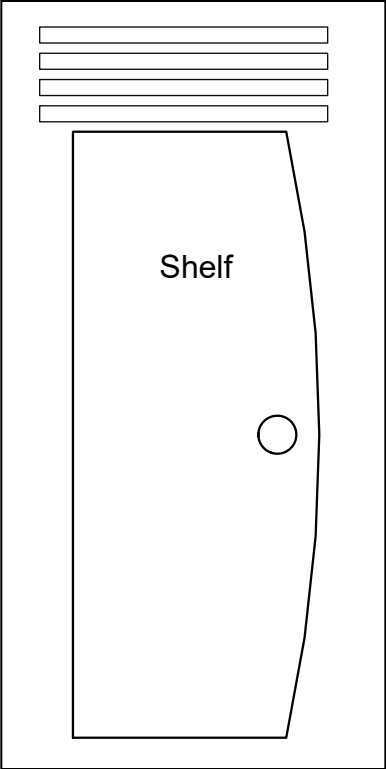

Level 2

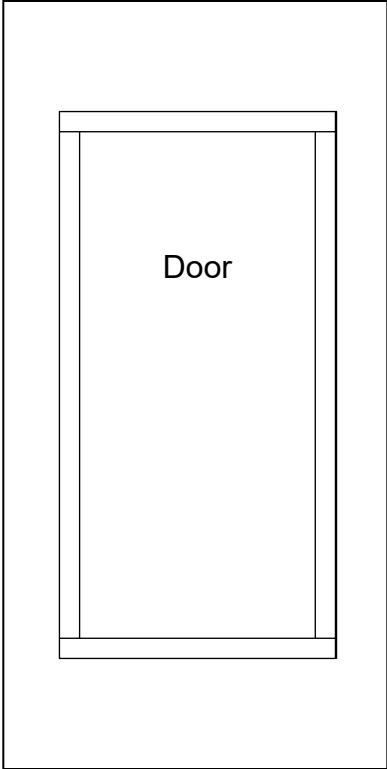

Level 3

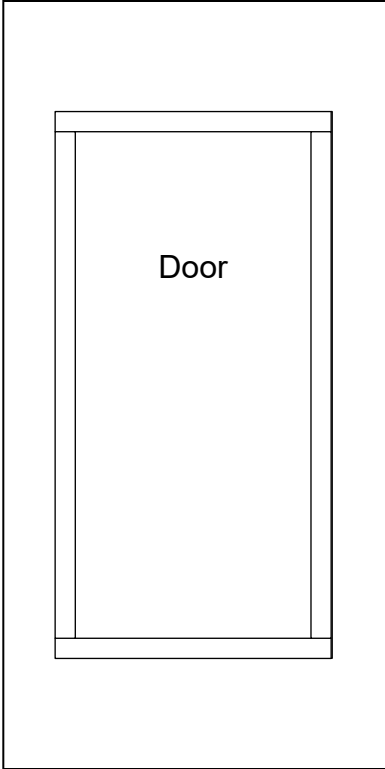

Level 4

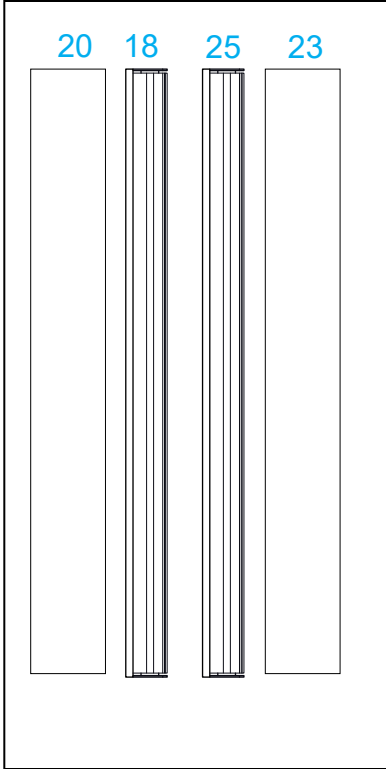

Level 5

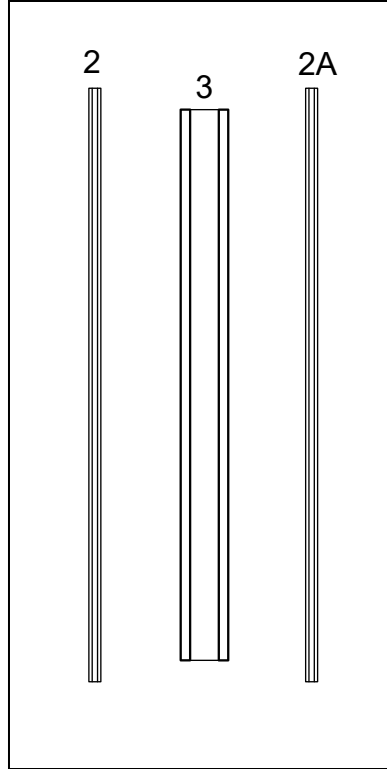

Level 6



Top View of Each Level

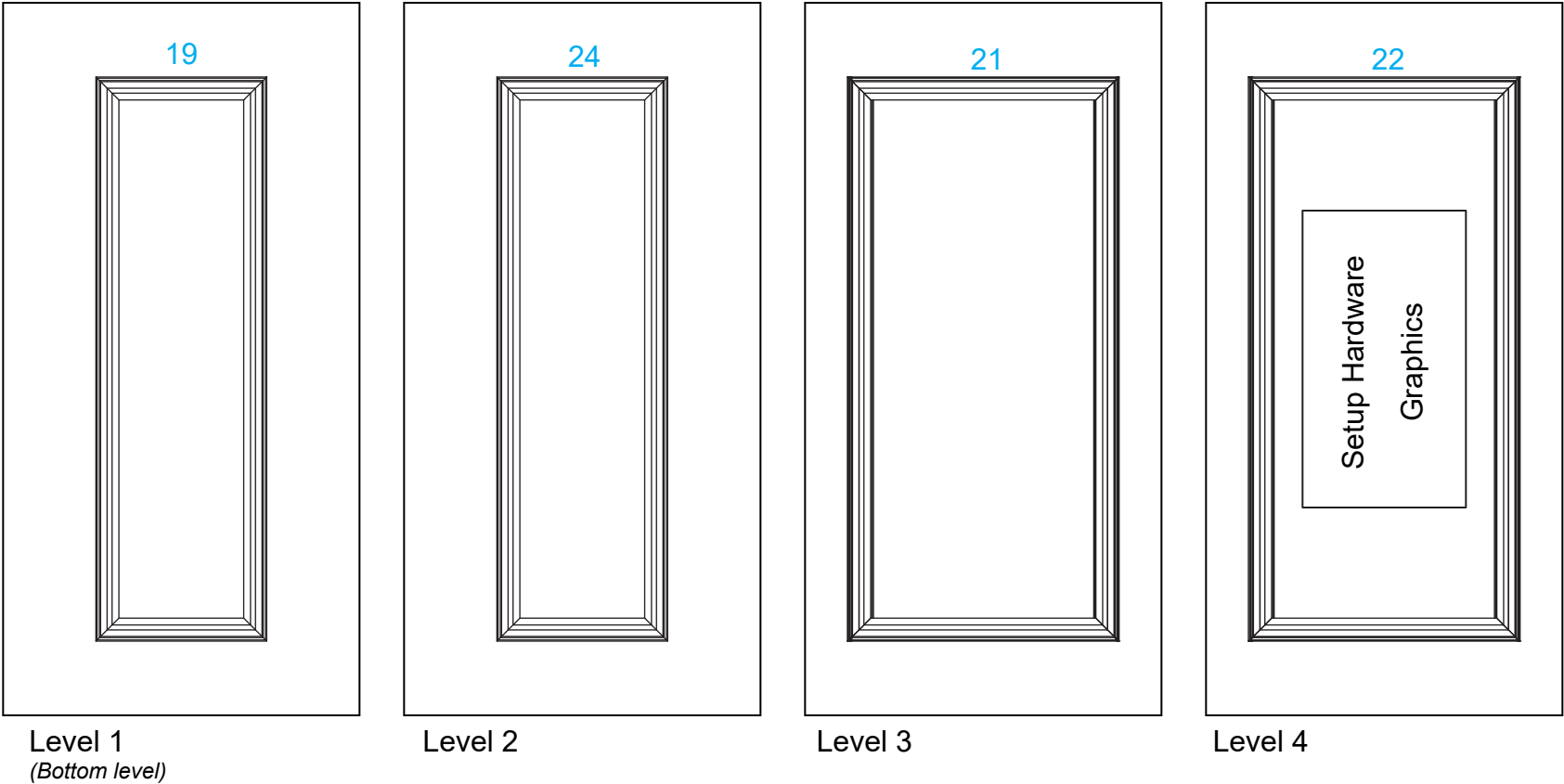

Item	Qty.	Description
18	1	37.5"h Gravitee Corner Post w/ caps
19	1	11.5"w x 38"h Gravitee Panel
20	1	37.5"h Gravitee Hinged Connector
21	1	18.327"w x 38"h curved Gravitee Panel
22	1	18.327"w x 38"h curved Gravitee Panel
23	1	37.5"h Gravitee Hinged Connector
24	1	11.5"w x 38"h Gravitee Panel
25	1	37.5"h Gravitee Corner Post w/ caps
1/1A	1/1	38"h S10 Vertical Extrusion
2/2A	1/1	37.0945"w Z45 Horizontal Extrusion w/ Door Hinge
3	1	34.417"h Z45 Horizontal Extrusion w/ Door Stops

- Steps:
- 1) Assemble Gravitee panels & posts [18] through [25], in numerical order as shown.
  - 2) Connect vertical extrusion [1] to post [18]; attach vertical [1A] to post [25].
  - 3) Attach horizontal extrusions [2,2A] between posts [18,25].
  - 4) Install Doors to [18/1] & [25/1A]. See **Door Attachment** detail.

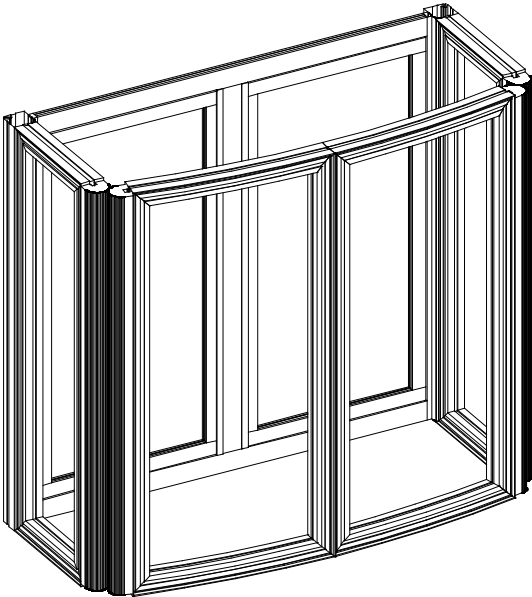

When assembled

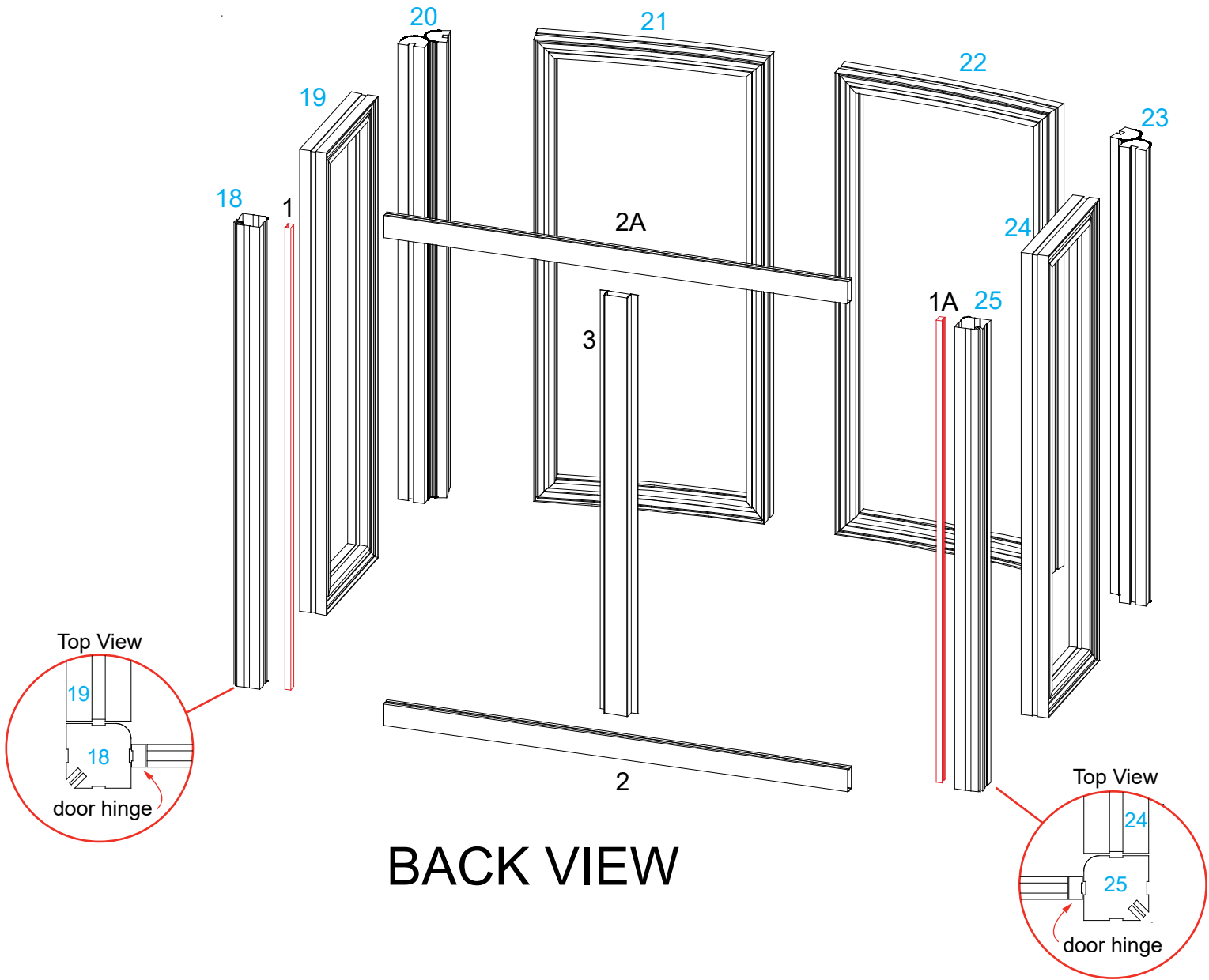

BACK VIEW

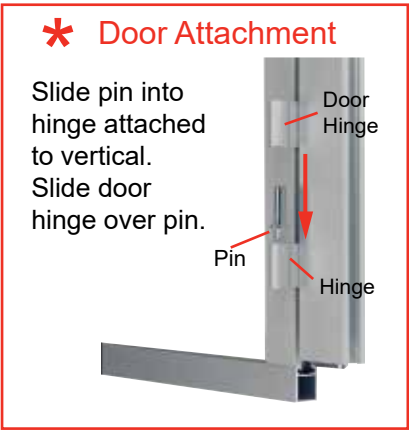
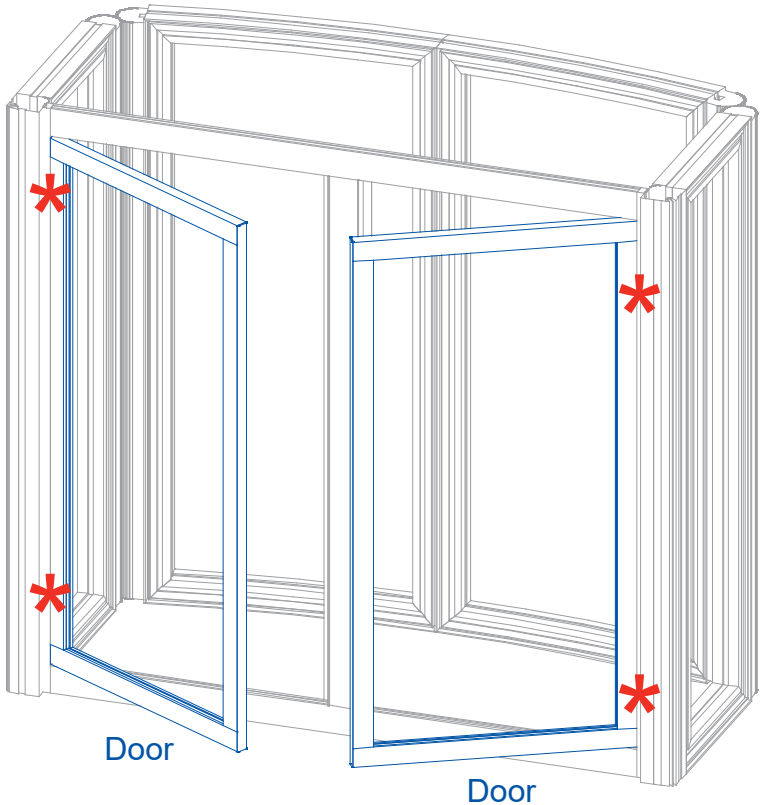

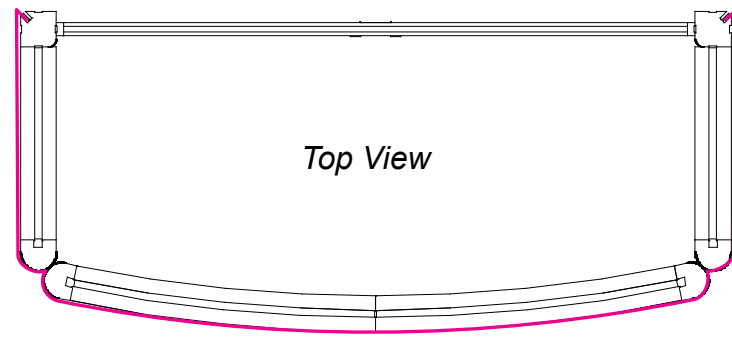

Steps:

- 1) Wrap **SEG Graphic** around front & sides of Counter, as shown.
- 2) Attach **Shelf Supports** using Velcro; place Internal **Shelf**.
- 3) Place **Counter Top** on top of assembly & secure in place.

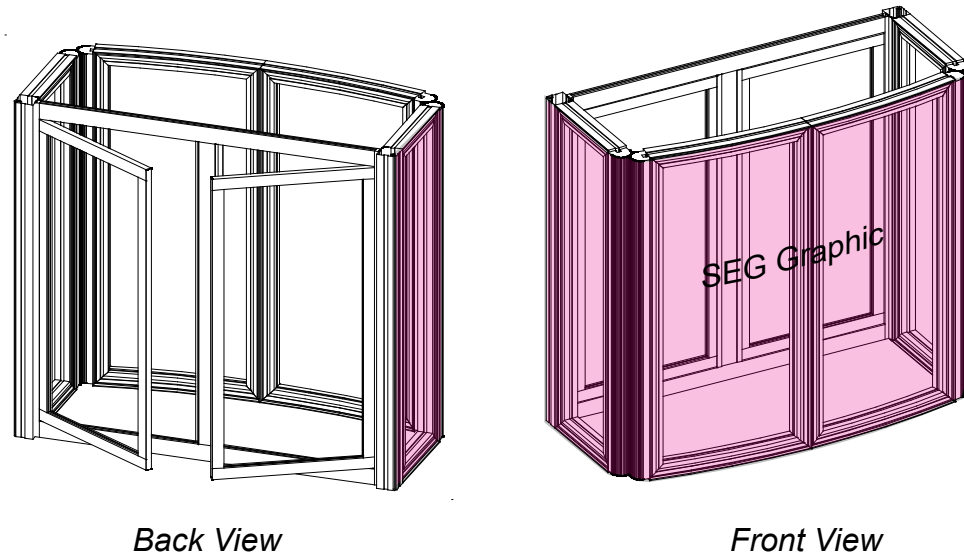
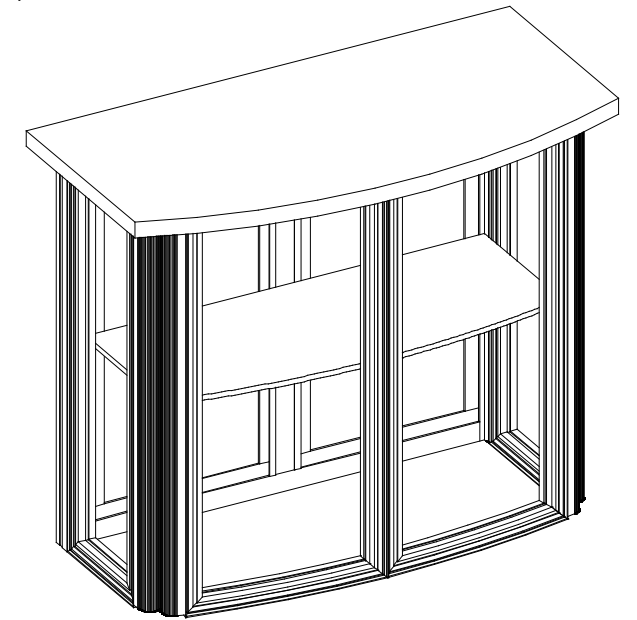

For SEG Graphic Installation  
See General Information Pages.

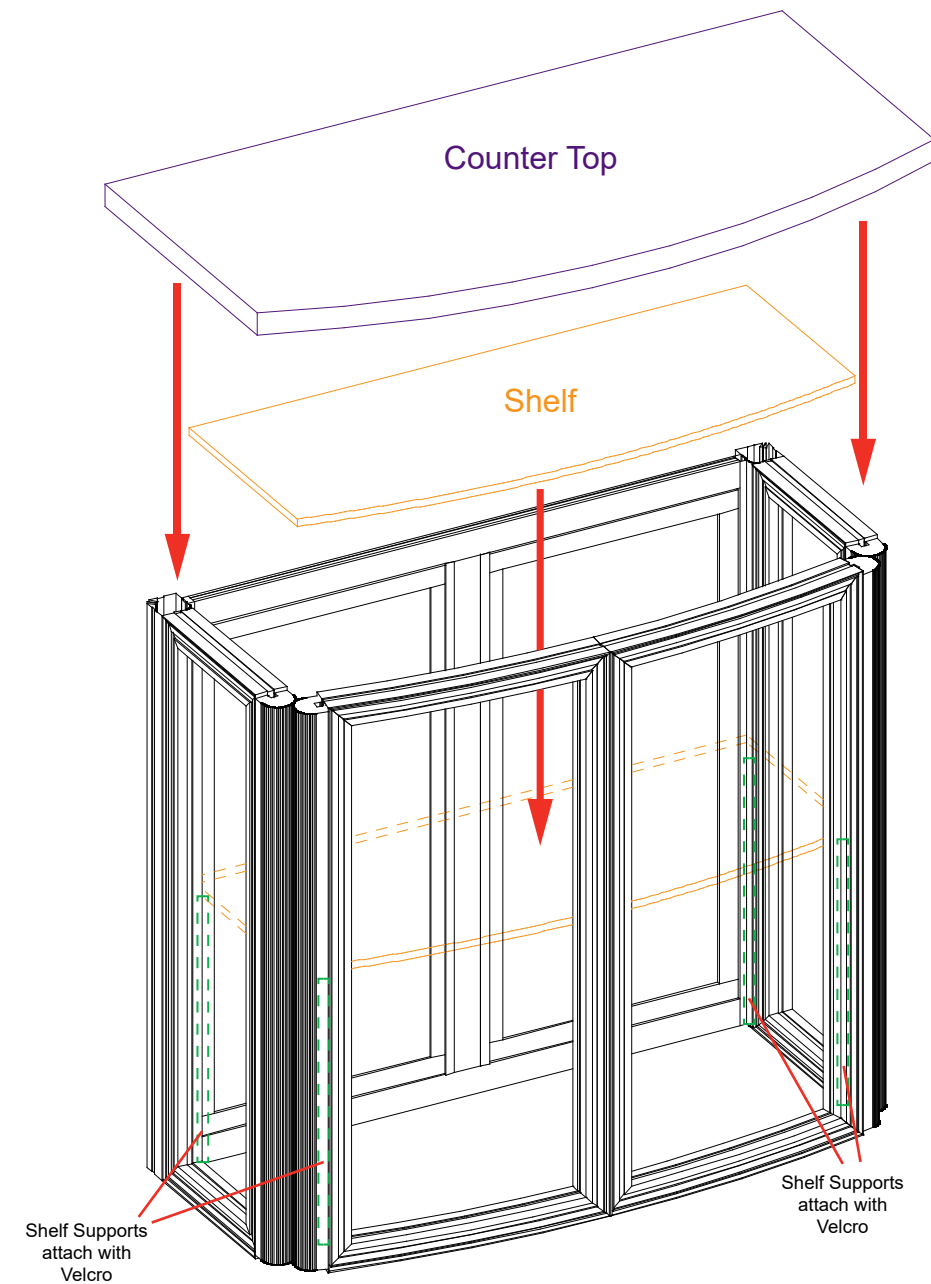

#### Counter Top Attachment

